

## Double Open Stove



### Product Features:

- Gas energy saving up to 50%
- User Friendly
- Noise reduction
- Heat Accumulate
- Safe and easier
- Flameout protection

### Specifications:

Name	Model	Dimension			Heat BTU (kw)	Type of Gas
		L	D	H		
Single Open Stove	DN-BL-STV1-650	650	700	500+720	42	LPG/CG
Double Open Stove	DN-BL-STV2-1300	1300	700	500+720	2x42	

Single Open Stove

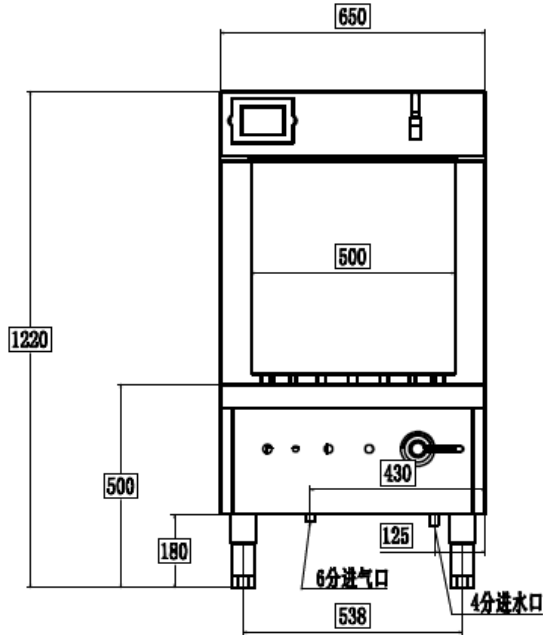

Double Open Stove

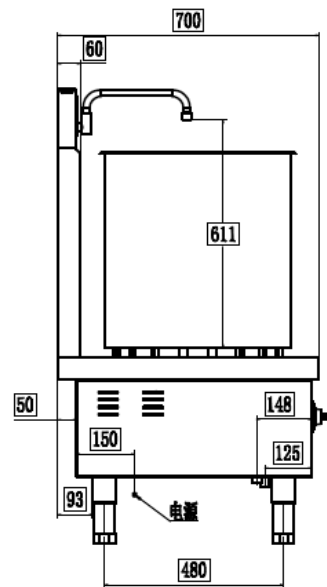
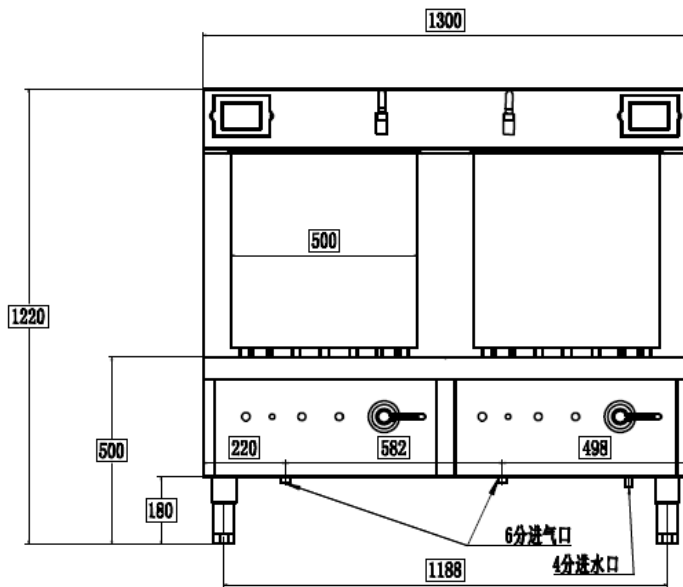

DANENG ENERGY-SAVING TECHNOLOGY PTE LTD

Sales Hotline : +65 6747 0435  
 Service Hotline : +65 6846 1160  
 Email : sales@daneng.com.sg  
 Address : 3 Kaki Bukit Industrial Terrace, Singapore 416091  
 Facebook : www.facebook.com/DaNengKitchenEquipment

